

version: march 2025

Instruction manual



from haze**base**



www.hazebase.com

Scope of delivery

- Bazer as standard in a flight case
- Fuel tank cap with quick coupling
- Power cord with TrueOne plug
- spare vaporizer
- Instruction manual

Please check the completeness of the delivery

content

1. Introduction.....	3
2. safety instructions.....	4
3. Designation of the parts.....	5
4. Preparation.....	6
4.1 Select of the location.....	6
4.2 Changing the fluid bottle.....	6
4.3 haze outlet.....	6
5. haze fluid.....	7
6. Working with the Bazer.....	7
6.1 Control panel of the Bazer.....	8
6.2 Operation in the stand-alone mode.....	8
6.3 Operation via DMX512/RDM.....	9
6.4 Operation via cable remote (option).....	10
6.5 Operation via radio remote (option).....	10
6.6 Operation via internal timer.....	12
7 options menu.....	13
7.1 Consumption status of the vaporizer.....	13
7.2 Setting the communication protocol of the XLR jacks.....	13
8. Changing the vaporizer.....	14
9. Care and maintenance.....	15
10. Troubleshooting.....	16
11. Error messages.....	17
12. Technical data.....	18
12. Warranty conditions.....	19

1. Introduction

The Bazer is a haze generator of the latest generation. It offers a wide range of possibilities to display your lighting effects even better.

The Bazer is used to generate haze. This creates the atmospheric effect that is necessary for an appealing light show.

Almost any desired haze density can be created by adjusting the pump output and fan speed.

A tried-and-tested, glycol-based and highly concentrated fluid is used. In combination with a fine nozzle, it produces the finest droplets with a long service life in the air.

The extremely quiet and adjustable fan enables use in areas where background noise is a nuisance.

The Bazer also offers several control options. In addition to direct the device using a membrane keypad, the haze generator can be controlled via DMX512/RDM, as well as via wired and wireless remote controls (optionally available).

The 2 litre canister lasts from approx. 35 hours at the lowest settings up to 6.5 hours at maximum output.

The Bazer's directly heated vaporizer reaches operating temperature in less than 5 seconds and requires only 330W despite extremely high output rates. Its wide-range input (100V-240V AC) allows it to be used all over the world.

Furthermore, the vaporizer can be easily replaced after the operating hours have been reached. This is done conveniently from the outside via a service flap.

2. safety instructions

- Very hot steam escapes from the mist outlet. Caution: **Danger of burns!**
- During the fogging process, very hot fluid droplets may occasionally escape from the fog outlet opening. Therefore, there must be no persons or heat-sensitive objects within a distance of 1.5 m from the fog outlet opening.
- Never handle the mist outlet opening during operation or when it is activated.
- The device must be set up in a place that is not sensitive to heat. Keep a minimum distance of 60 cm from flammable, combustible and heat-sensitive objects.
- The fog fluid used contains glycerine, which burns with a slightly bluish, almost invisible flame. Therefore, never mist into strong ignition sources such as open fires.
- Never open the device connected to a power source.
- During operation, sporadic leakage of hot fluid droplets is possible. Care should therefore be taken to ensure that these cannot become a hazard to people. Keep a safety distance of 3m to the fog outlet nozzle.
- Do not ingest the fog fluid and keep it away from children. In case of eye contact, rinse with plenty of water. In case of accidental ingestion, consult a physician.
- Spilled or splashed fluid may cause slipping hazard. Absorb fluid and dispose of as directed.
- Do not allow visibility to drop below 2m, you are responsible for persons moving in the fogged area.
- The generated fog may set off smoke detectors.
- The vaporizer tube may be very hot ! Allow it to cool down for approx. 5 minutes before replacing it.

The method used here to generate artificial fog is largely harmless and is used worldwide in the entertainment sector. We are not aware of any case in which a healthy person has been harmed by the use of this artificial fog.

Nevertheless, we recommend that people who are ill or have previous respiratory damage or a tendency to allergies avoid contact with artificial fog!

3. Designation of the parts

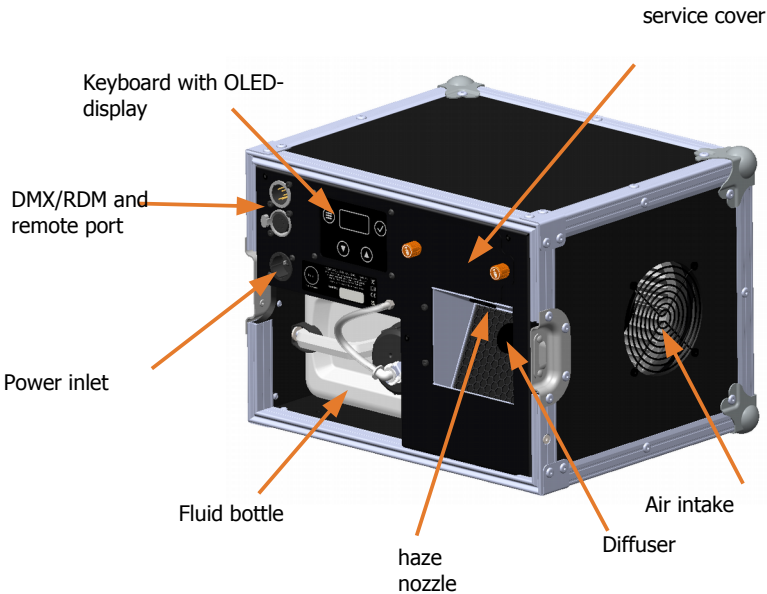

4. Preparation

4.1 Select of the location

The location where the Bazer is operated must

- have good ventilation, with cold and fog-free air
- be dry
- be vibration and shock free
- consist of a non-flammable footprint
- be far enough away from easily flammable objects
- have an ambient temperature between 5°C and 45°C
- have a relative humidity of less than 80%.

4.2 Changing the fluid bottle

- Release the plug-in nozzle from the quick coupling by pressing the locking button
- Loosen the Velcro fastener on the canister
- Remove the bottle from the case
- Unscrew the tank cap from the empty bottle and screw it onto a new, or full, bottle.
- Push the fluid bottle back into the case
- Secure the bottle again with the Velcro fastener
- Re-insert the plug-in nozzle into the tank cap.

4.3 haze outlet

The fog outlet of the Bazer is inclined upwards by approx. 30°. To achieve even steeper angles, the cover of the case can be placed under the front of the Bazer. However, the angle can also be reduced by placing it under the back of the device.

No type of air deflector may be fitted to the outlet nozzle, otherwise the haze may enter the vaporizer chamber.

5. haze fluid

Please use only the original base*B Fluid for the **Bazer**

6. Working with the Bazer

The Bazer is a haze generator of the latest generation. It can be used to create anything from the finest haze to a fog-like effect.

The effect can only build up slowly. You should therefore switch on the device some time before use.

Please ensure that there are no objects in the way of the air inlet or outlet are attached to the air inlet or outlet so that free circulation is possible.

After plugging in the mains plug, the main menu appears. The machine does not yet heat up does not yet heat up, as this takes less than 5 seconds and only takes place when required.

6.1 Control panel of the Bazer

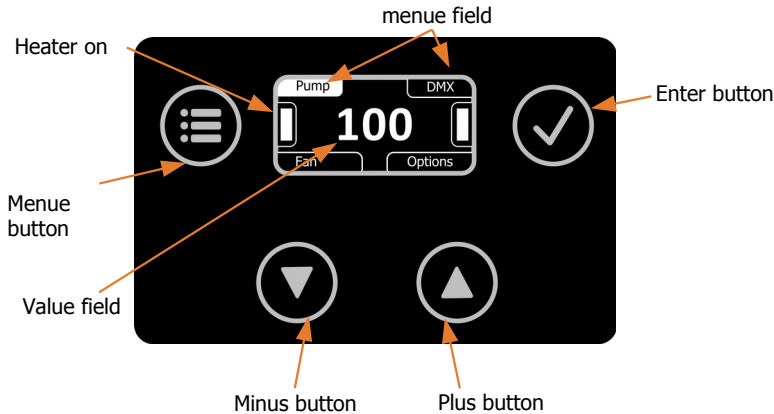

The Bazer is operated via the four push buttons (menu, minus, plus, confirmation) and the OLED display. The menu fields are located in the corners of the display, and the value field in the center, which displays the value of the selected menu field. The menu key is used to select the individual menus counterclockwise. With the help of the plus and minus keys, the corresponding value can then be changed and then saved with the confirmation key.

A white bar on the left and right of the screen indicates whether the start or stop process has been initiated. The bars build up during the start process, which takes 5 seconds. During the switch-off process, these bars become smaller and smaller until the heating and fan are finally deactivated. This vaporises all fluid droplets still in the heating element.

6.2 Operation in the stand-alone mode

The simplest case of control is the stand-alone mode. For this, the pump value is set to the desired value and the confirmation key is pressed. The heating element is heated up and the haze process starts after a few seconds as soon as the correct temperature is reached.

The pump value can also be changed during the haze process.

Pressing the confirmation key again stops the haze process again.

The same applies to the setting of the fan value.

6.3 Operation via DMX512/RDM

When operating via DMX512, the XLR input must first be set to DMX (see chapter Options).

As shown, "DMX" appears in the upper right menu field. The DMX address can be changed with the plus and minus keys and must be stored afterwards with the confirmation key.

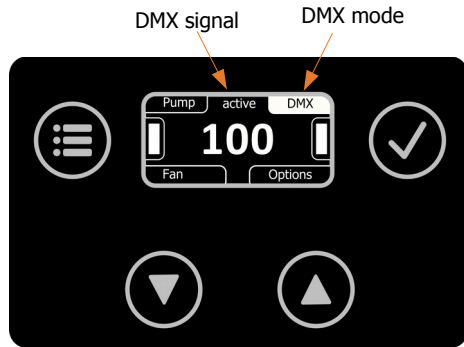

If a valid DMX signal is present, this is indicated at the top center with "active". The currently read pump value can be displayed by selecting the pump menu item. If the received value is greater than zero, the Hazer² starts the haze process and stops it accordingly at the value zero.

The Bazer has two DMX channels. Channel 1 is assigned to the pump, channel 2 sets the fan speed.

Via RDM the Bazer is configurable (DMX address) as well as readable (error or temperature data). Furthermore, a firmware update can be done via this RDM input.

6.4 Operation via cable remote (option)

When operating via the cable remote, the XLR input must first be set to Remote (see chapter Options).

After plugging in the cable remote control, the Bazer automatically recognizes that an analog cable remote control has been plugged in. On the cable remote control there is a power switch and a potentiometer for setting the pump value. The fan speed must still be set on the device.

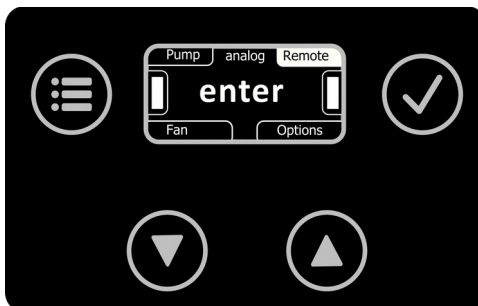

6.5 Operation via radio remote (option)

When operating via radio remote control, the XLR input must first be set to Remote (see chapter Options).

After plugging in the radio remote control, the Bazer automatically recognizes that a radio remote control has been plugged in.

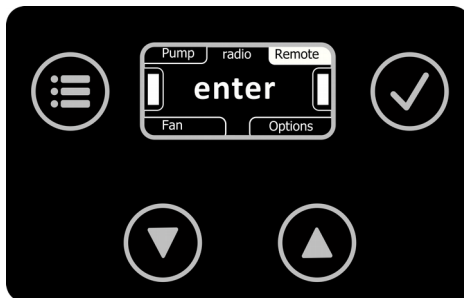

Up to 60 different radio remote transmitters can be programmed on the machine. For this purpose, the "Remote" submenu must first be selected.



In the Remote submenu, the menu fields are replaced. At the top left, the channel (key on the hand-held transmitter) can be selected. At the bottom left, a new radio remote transmitter is taught-in and at the bottom right, the taught-in hand-held transmitters are deleted again.

A new hand-held transmitter is taught as follows. First select the menu item add and confirm this with the confirmation key. „Adding“ now appears at the bottom left. The machine now waits for a valid radio signal. To do this, press any key on the handheld transmitter. The teach-in process is now complete and "add" appears again at the bottom left. You can then select the key and save it.

To delete the already taught-in handheld transmitters, select the menu item "del" and confirm it. At the bottom right, "deleting" now appears. The deleting process is now in progress. The display changes back to "del" after a successful deleting process.

The radio remote control on the Bazer is generally designed as an on/off mode. Pressing it for the first time starts the process, pressing it again stops the process.

To exit the submenu, the menu item "exit" must be selected and confirmed with the confirmation key.

6.6 Operation via internal timer

To set and activate the internal timer, you must first switch to the "Timer" submenu in the "Options" menu.

The menu fields are also changed accordingly here. The pump value used in timer mode can now be set at the top left. The fan speed value can be set accordingly at the top right.

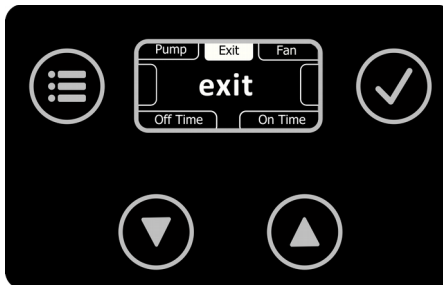

The waiting time can be set in minute increments at the bottom left. Similarly, the fogging time can be set in minute increments at the bottom right.

To activate the timer, the confirmation button can be pressed for both the waiting time and the fogging time. This activates or deactivates the timer. Depending on the selected menu item, the timer starts with the waiting time or the fogging time.

The pump value can still be changed even when the timer is activated. With the Bazer, the fan is activated with the manually set value analogue to the fog output. As fans require a certain start-up time, the fan is started prematurely in order to reach full speed during the fogging process.

The timer in the Bazer has an autostart function. This is activated when the timer is activated. If the Bazer is disconnected from the power supply in this state, it will restart with the timer activated the next time.

ATTENTION ! Please ensure that the power is disconnected in the pause state, otherwise fluid may remain in the vaporiser and escape unvaporised from the nozzle at the next start.

If the "Timer" submenu is exited again, the timer is also deactivated.

7 options menue

In the "Options" submenu, the status of the vaporiser can be read and the protocol of the XLR sockets can be selected. The timer can also be found here.

7.1 Consumption status of the vaporizer

This menu item displays the status of the vaporizer. The life time of the vaporizer tube is approx. 8 litres of fluid consumption. The tube slowly clogs up as consumption increases. If the vaporizer needs to be replaced, a warning is displayed when the machine is started.

Once the vaporizer has been replaced (chapter 8), the consumption display is reset to 0%.

7.2 Setting the communication protocol of the XLR jacks

In the menu item "Input" the communication protocol of the XLR sockets can be selected. The following protocols can be selected here:

- DMX/RDM
- Remote (cable or radio)

Please select the desired protocol and confirm it with the confirmation button.

8. Changing the vaporizer

A thin stainless steel tube is installed in the Bazer for vaporization to produce the finest droplets. This tube becomes clogged over time. The vaporizer must therefore be replaced regularly. This is done through the service cover in the device. As a rule, even without tools, occasionally a multitool is required.

The device is always supplied with a replacement vaporizer.

This is located in the lid of the flight case. First loosen the two knurled screws to open the service cover.

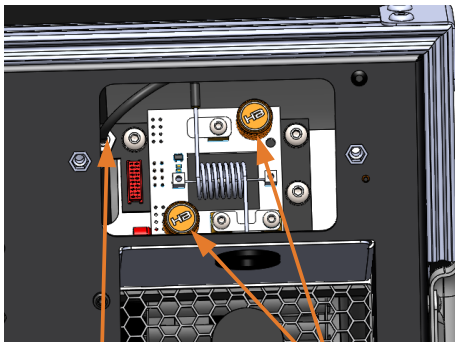
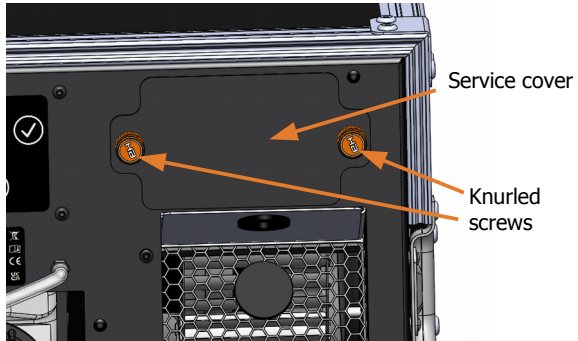

Loosen the two knurled nuts on the vaporiser. Now pull the entire vaporizer board straight out. Then disconnect the hose from the hose nozzle.

Install the new vaporizer in reverse order.

Please ensure that the pin headers on the left-hand side of the board are not damaged when inserting.

The service cover is secured by a microswitch so that the vaporizer is de-energised as soon as the cover is opened.



**If in doubt, the vaporizer tube may still be very hot!
Allow it to cool down for approx. 5 minutes**

9. Care and maintenance

- Avoid running the Bazer without fluid. The pump will otherwise run dry.
- Avoid overheating the device due to direct sunlight or direct spotlight. The permissible ambient temperature can be found in the technical data.
- Make sure that the ventilation slots of the machine are not clogged with dust deposits. If necessary, the ventilation slots must be cleaned.
- Wipe up leaked fluid immediately.
- Check the suction strainer in the tank from time to time. Clean it or replace it.
- If you use the same fluid bottle frequently, you should rinse it thoroughly before each filling with fresh fluid. This will prevent contamination.
- If necessary, clean the surface of the device with a suitable, solvent-free cleaning agent
- Make sure that sufficient mist-free cooling air permanently surrounds the machine. Otherwise, moisture damage could occur inside the machine.
- after a few hours of operation, condensate droplets may have formed in the discharge area. This does not represent an operating fault. Please clean the area only when the machine has cooled down.
- **PLEASE NOTE:** The vaporizer of our fog machines does NOT need to be cleaned! Cleaning fluids offered on the market can damage the vaporizer! The warranty will be void in this case.

10. Troubleshooting

The **Bazer** does not haze

- Check external control
- Check power source
- Check fluid quantity
- Check connection at fluid tank for tightness
- Check suction strainer in tank for contamination
- Check fluid hose and connector for tightness

The **Bazer** clacks loudly when hazing

- The pump runs dry. This must be avoided at all cost
- Refill fluid
- Check hose and coupling, engage again if necessary.

11. Error messages

The Bazer shows the error message "machine too hot" in the display

- The temperature inside the device is too high. After cooling down, the error disappears again.

The Bazer shows the error message "faulty vaporizer – low voltage" in the display

- Something is wrong with the vaporizer. The machine switches off for safety reasons. The reason could be a defective thermal fuse or a fault in the power supply.
- Please replace the vaporizer. If the error persists, please send the Bazer to the service centre.

The Bazer shows the error message "flap open" on the display

- The service cover is open, the vaporizer is de-energised for safety reasons.

The Bazer shows the error message "vaporizer not present or broken" in the display

- The memory on the vaporizer board could not be read. Please check that the vaporizer is seated correctly. The pin headers could also be bent.

The Bazer shows the error message "Warning – change the vaporizer" in the display

- The vaporizer is worn out. Please install a new one.

12. Technical data

Bazer

Device type	fog machine with directly heated vaporizer and fan
Form factor	Flightcase (ca. 320x240x265/345 mm)
Power	100-240V~, 50-60 Hz, 330 W (PowerCON TRUE1)
Heat up time	appr. 5 sec.
Fluid bottle size	2 litres
Fluid consumption	Up to 5 ml /min.
Haze density	1-100% controllable
Fan	Radial fan 250m ³ /h (147 cfm), IP65, Speed: Adjustable 1-100%
DMX-Footprint control	2-Channel (pump and fan speed) 1,3" OLED-Display, keypad
Control ports	5 pol XLR In/out
Supported protocols	DMX512, RDM, JT-Remote
Fluid	base*B
Vaporizer	quick changeable through service flap
weight (kg)	appr. 11 kg (25 lbs)

12. Warranty conditions

hazebase provides warranty for the purchased haze machine Bazer according to the following conditions:

1. We shall remedy free of charge in accordance with the following conditions (Nos.
2 to 6) damage or defects to the device which are demonstrably due to factory defects if they are reported to us immediately after discovery and within 24 months after delivery to the end user. A warranty obligation is not triggered by minor deviations from the nominal condition which are insignificant for the value and usability of the device, by damage from the effects of water and generally from abnormal environmental conditions or force majeure.
2. The warranty service is provided in such a way that defective parts are repaired free of charge or replaced by faultless parts at our discretion. Devices for which a warranty claim is made with reference to this warranty must be handed over to us and sent free of charge. The proof of purchase with the date of purchase and/or delivery must be presented. Replaced parts become our property.
3. The warranty claim expires if repairs or interventions are carried out by persons who are not authorized by us to do so or if our devices are equipped with supplementary or accessory parts that are not matched to our devices. Furthermore, the warranty claim expires if a fog fluid other than the original hazebase fog fluid was used. If the devices are sent to us without prior removal or emptying of the fluid canister, the warranty also expires, as well as in the case of demonstrable disregard of the operating instructions or in the case of faults due to improper handling/handling as well as in the case of damage due to the effects of violence.
4. We do not grant any performance claims for components or component groups what are subject to natural wear or normal wear. In particular, all fluid-conveying parts such as pumps and heating elements are considered to be wearing parts. A goodwill settlement will be checked in each individual case.
5. Warranty services do not cause an extension of the warranty period, nor do they start a new warranty period. The warranty period for installed spare parts ends with the warranty period for the entire device.

6. If a damage or defect cannot be remedied by us, or if the remedy is refused or unreasonably delayed by us, within 6 months from the date of purchase/delivery, at the request of the end user either
 - a. replacement delivered free of charge or
 - b. the reduced value is remunerated or
 - c. take back the device for a refund of the purchase price, but not more than the market price.
7. Further or other claims, in particular those for compensation for damage occurring outside the device, are excluded - unless liability is mandatory by law.



hazebase
Stargarder Strasse 2
30900 Wedemark

Deutschland

Inhaberin: Uta Raabe
Telefon: 0049-5130-37 10 05
Telefax: 0049-5130-37 10 06
Email: info@hazebase.com
Internet: www.hazebase.com